

3/8" Dishwasher Appliance Kit Specifications

Application

LeakSmart® Dishwasher Leak Detection & Shut-Off Valve detects leaks and shuts off your dishwasher supply line in less than 5 seconds, protecting you from devastating water damage. Plus, it alerts you when detecting water leaks with audible and visible alarms. The valve is installed on the hot water tanks incoming cold supply. Everything is pre-wired to simplify the installation.

Additional Applications - Water Filters & Toilets

Features

- Full port valves
- Quick connect wiring
- AC power with battery back-up
- LED status light, visual alarm
- Audible alarm
- Alarm mute
- 3 LED status lights
- Self test feature
- Low voltage
- Output trigger
- 5-year manufacturer's warranty*

Product Specifications

- Max. operating pressure:** 150 PSI
- Max. ambient temperature:** 130° F (54° C)
- Min. water temperature:** 33° F (1° C)
- Max. water temperature:** 190° F (88° C)
- Valve connection type:** 3/8" Compression Fitting
- Input AC Voltage:** 110 to 240 VAC, 50/60 Hz
- DC Output:** 9 Volt

Material

- Control panel:** High performance engineered polymer
- Valve:** Lead free brass

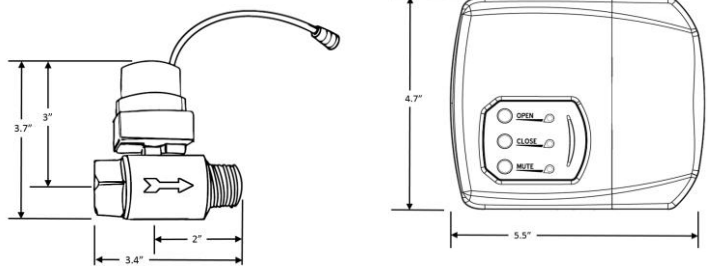
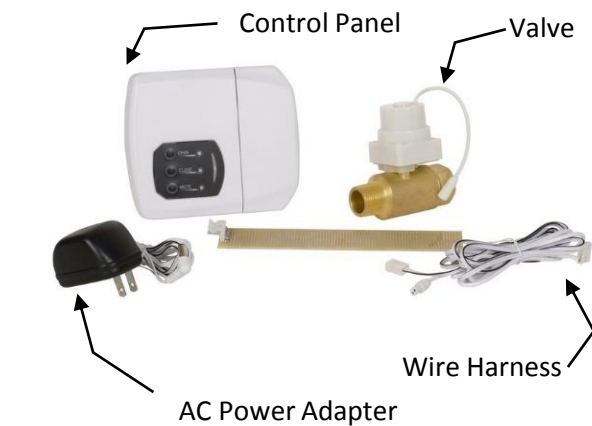

* Dimensions for reference purposes only

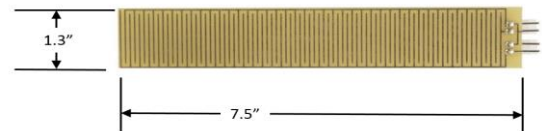

* Included in kit, additional sensors sold separately. Item#8820700

Approvals



* 5-year manufacturer's warranty when purchased and installed by a professional installer.